



M E R I D I A N

147 S. CHERRY STREET, SUITE 200 | WINSTON-SALEM, NC 27101 | P 336.722.1986 | F 336.723.3173 | MERIDIANREALTY.COM

2,296± SF Office Space

1315 Westbrook Plaza Dr

Winston-Salem, NC 27103



Property Details:

The property is situated near major roads, including Stratford Road, Silas Creek Parkway, and Hanes Mall Boulevard, ensuring convenient access and visibility. It is ideal for professional or commercial uses, benefitting from a strategic location in a busy commercial area. The location provides excellent connectivity to nearby retail, dining, and business hubs. Close proximity to significant infrastructure like Hanes Mall and major transit routes.

For more information:

Charlie H. Fulk, CCIM
Cfulk@meridianrealty.com
336.480.2089

FOR LEASE: \$18 PSF Mod Gross

WWW.MERIDIANREALTY.COM

Floorplan

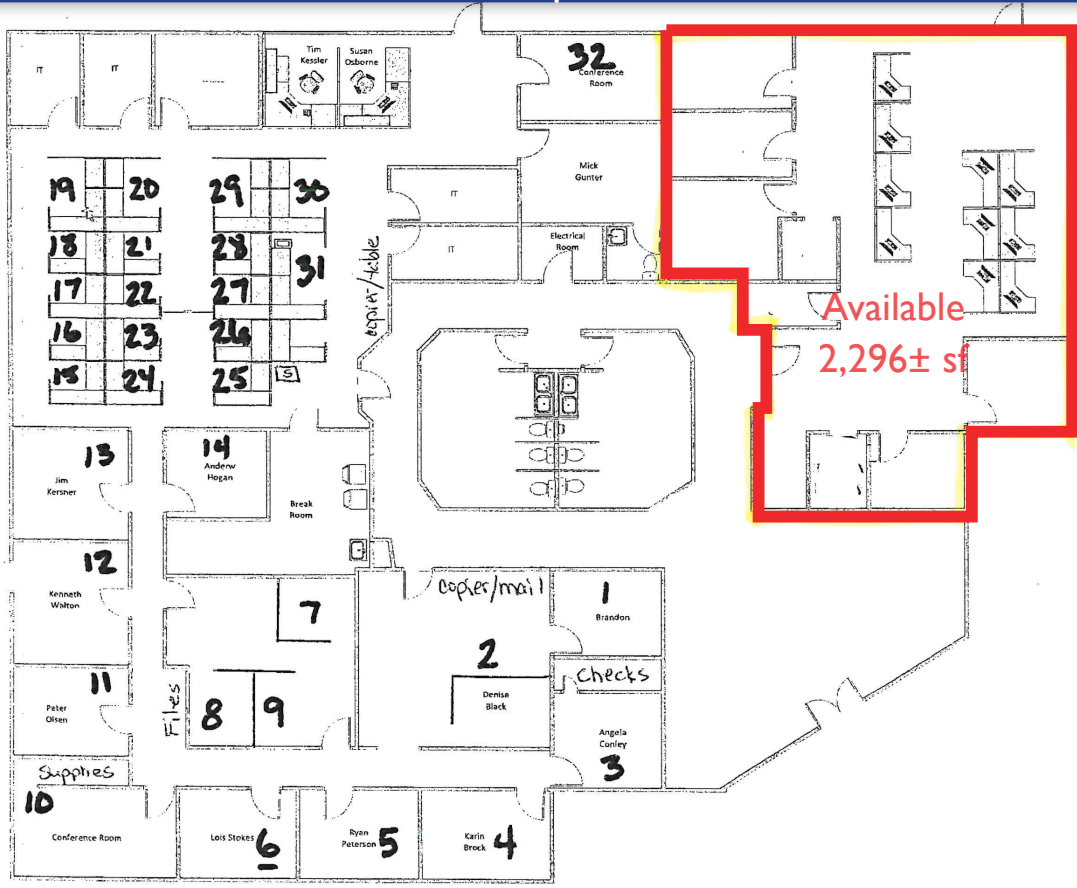

No warranty or representation (express or implied) is made as to the accuracy or completeness of the information set forth herein. All information is submitted subject to errors, omissions, change of price, prior lease or sale, and withdrawal without notice. All marketing material produced by the Meridian Realty Group is proprietary. Any reproduction is expressly prohibited.



THE MERIDIAN REALTY GROUP | 147 S. CHERRY STREET, SUITE 200 | WINSTON-SALEM, NC 27101

P 336.722.1986 | F 336.723.3173

WWW.MERIDIANREALTY.COM